

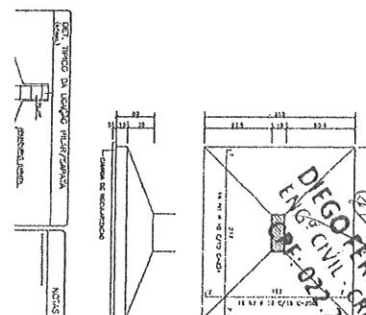

PEÇAS GRÁFICAS

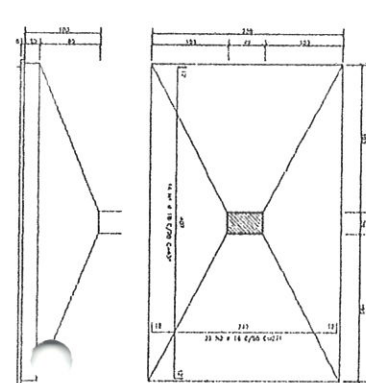
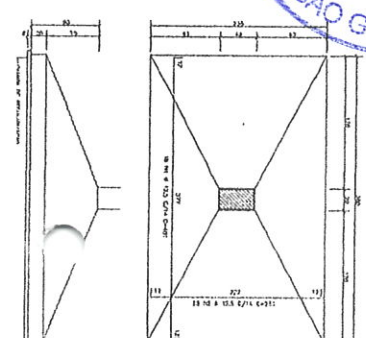
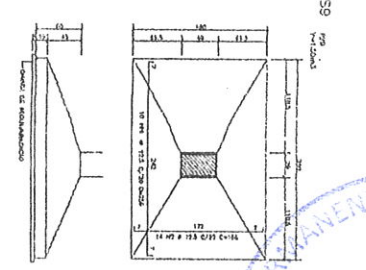
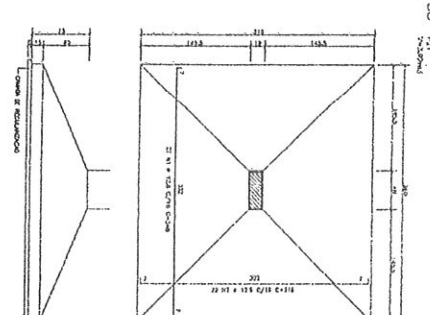
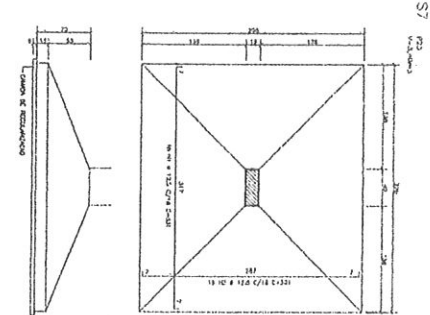
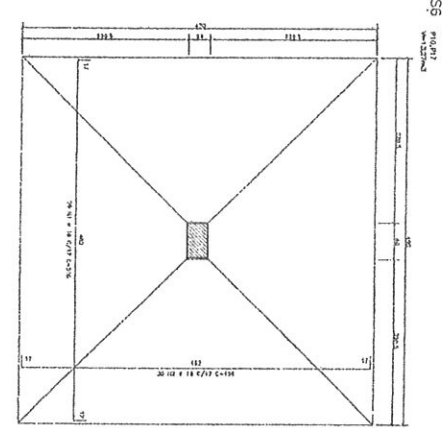
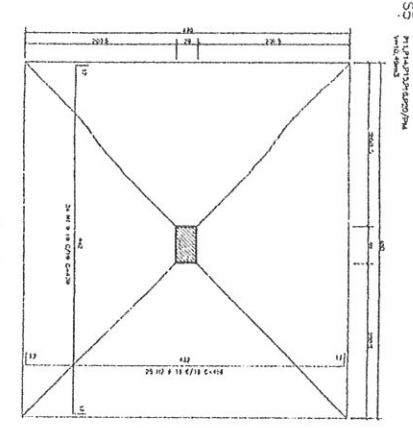
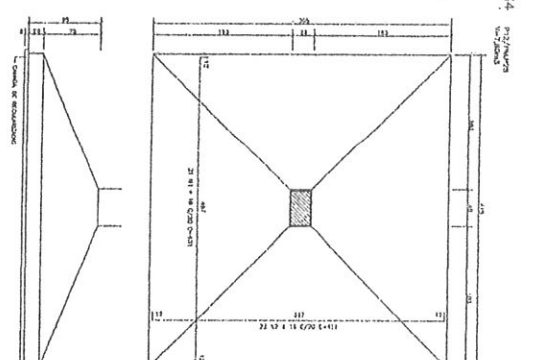
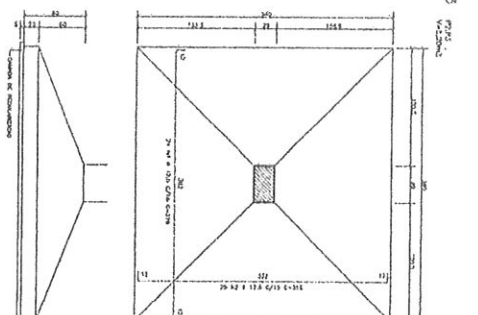
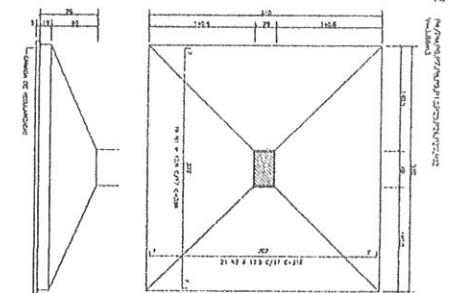
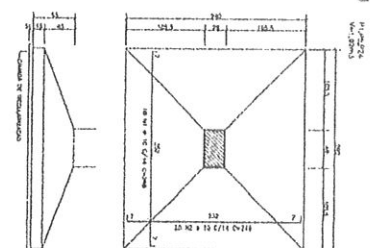
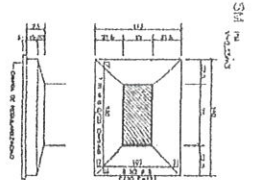

DIEGO FERNANDO LIMA
 ENGENHEIRO CIVIL - CREA 56373-D
 R. E. 022-224.053-94

ITEM	QUANTIDADE	UNIDADE	VALOR UNITÁRIO	VALOR TOTAL
01	1	MO	100,00	100,00
02	1	MO	100,00	100,00
03	1	MO	100,00	100,00
04	1	MO	100,00	100,00
05	1	MO	100,00	100,00
06	1	MO	100,00	100,00
07	1	MO	100,00	100,00
08	1	MO	100,00	100,00
09	1	MO	100,00	100,00
10	1	MO	100,00	100,00
11	1	MO	100,00	100,00
12	1	MO	100,00	100,00
13	1	MO	100,00	100,00
14	1	MO	100,00	100,00
15	1	MO	100,00	100,00
16	1	MO	100,00	100,00
17	1	MO	100,00	100,00
18	1	MO	100,00	100,00
19	1	MO	100,00	100,00
20	1	MO	100,00	100,00
21	1	MO	100,00	100,00
22	1	MO	100,00	100,00
23	1	MO	100,00	100,00
24	1	MO	100,00	100,00
25	1	MO	100,00	100,00
26	1	MO	100,00	100,00
27	1	MO	100,00	100,00
28	1	MO	100,00	100,00
29	1	MO	100,00	100,00
30	1	MO	100,00	100,00
31	1	MO	100,00	100,00
32	1	MO	100,00	100,00
33	1	MO	100,00	100,00
34	1	MO	100,00	100,00
35	1	MO	100,00	100,00
36	1	MO	100,00	100,00
37	1	MO	100,00	100,00
38	1	MO	100,00	100,00
39	1	MO	100,00	100,00
40	1	MO	100,00	100,00
41	1	MO	100,00	100,00
42	1	MO	100,00	100,00
43	1	MO	100,00	100,00
44	1	MO	100,00	100,00
45	1	MO	100,00	100,00
46	1	MO	100,00	100,00
47	1	MO	100,00	100,00
48	1	MO	100,00	100,00
49	1	MO	100,00	100,00
50	1	MO	100,00	100,00

SUPERIORE
 SUPERIORIA ESTADUAL
 Responsável Técnico:
JUAN CARLOS SANTOS
 OAB/CE 12874-5
 OAB/CE 12874-5
 OAB/CE 12874-5

Endereço: Rua da Liberdade, 250 - São José - Fortaleza - CE
 CEP: 60015-000

Telefone: (85) 3279-3728

Fax: (85) 3279-3728

E-mail: superioresp@superioresp.ce.gov.br

Site: www.superioresp.ce.gov.br

FORMA CIMENTADO - (TERREO)

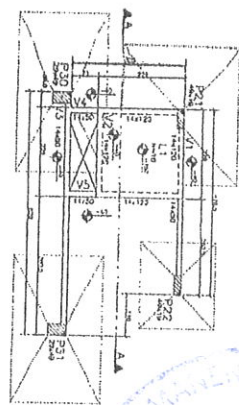

CORTE A - A
(Esc. 1:50)

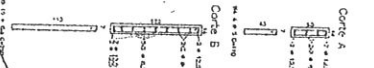
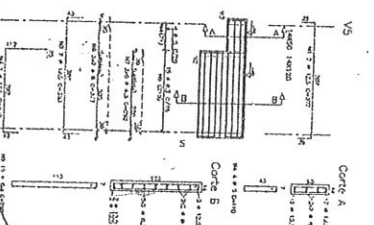
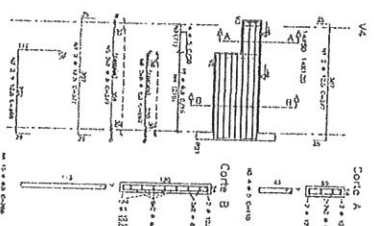
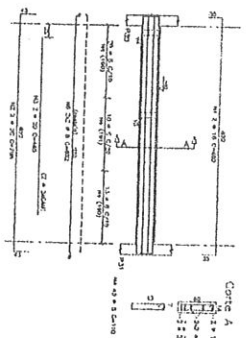
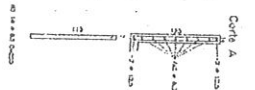
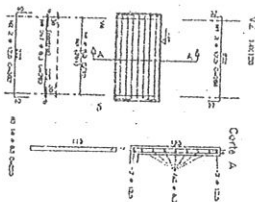
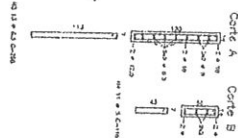
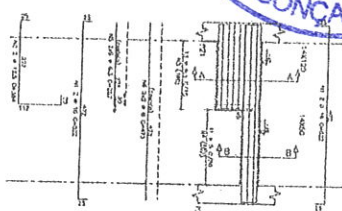
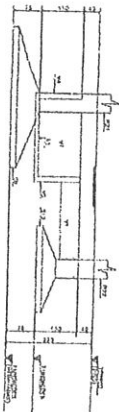

DIEGO FERNANDO LIMA
 ENG. CIVIL CREA: 56373-D
 C.P.F. 022.224.053-94

Item	Descrição	Quantidade	Valor Unitário	Valor Total
1
2
3
4
5
6
7
8
9
10
11
12
13
14
15
16
17
18
19
20
21
22
23
24
25
26
27
28
29
30
31
32
33
34
35
36
37
38
39
40
41
42
43
44
45
46
47
48
49
50

Item	Descrição	Quantidade	Valor Unitário	Valor Total
1
2
3
4
5
6
7
8
9
10
11
12
13
14
15
16
17
18
19
20
21
22
23
24
25
26
27
28
29
30
31
32
33
34
35
36
37
38
39
40
41
42
43
44
45
46
47
48
49
50

SUPROCON
 ENGENHARIA ESTRUTURAL

Responsável Técnico:
JUAREZ SILVA
 CRÉD. 004.548-4
 CREA/CE 000015-0

Endereço: Rua ...
 CEP: ...
 Telefone: (085) 2278-5728



FORMA ESCADA "CHECK" 1º ETIJO - (26,80M)
 (PROJETO Nº 17/2007)
 (Mês: 11/2007)

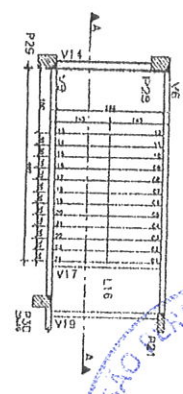

CORTE A - A
 (Mês: 11/2007)

FORMA ESCADA "CHECK" 2º ETIJO - (26,80M)
 (PROJETO Nº 17/2007)
 (Mês: 11/2007)

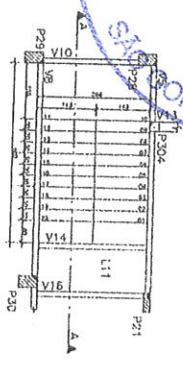

CORTE A - A
 (Mês: 11/2007)

FORMA ESCADA "CHECK" 2º ETIJO - (26,80M)
 (PROJETO Nº 17/2007)
 (Mês: 11/2007)

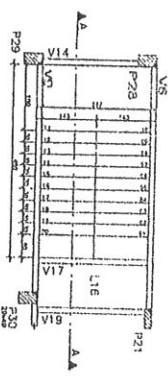

CORTE A - A
 (Mês: 11/2007)

FORMA ESCADA "CHECK" 4º ETIJO - (26,80M)
 (PROJETO Nº 17/2007)
 (Mês: 11/2007)

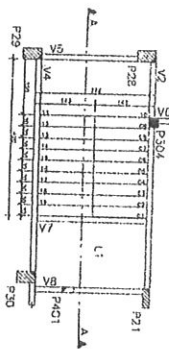

CORTE A - A
 (Mês: 11/2007)

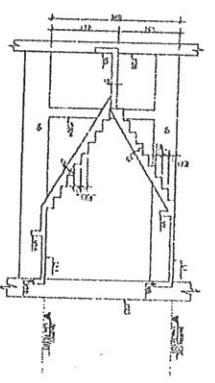
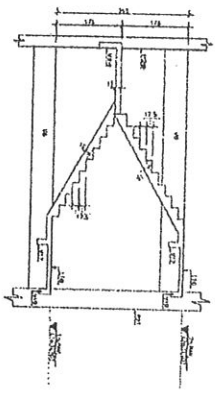

FORMA ESCADA "CHECK" 1º ETIJO - (16,80M)
 (PROJETO Nº 17/2007)
 (Mês: 11/2007)

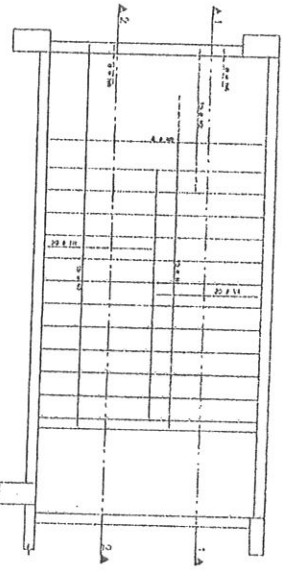

CORTE 2 - 2
 (Mês: 11/2007)

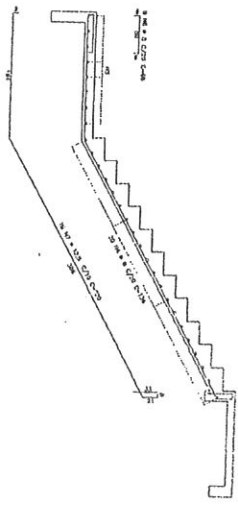

CORTE 1 - 1
 (Mês: 11/2007)

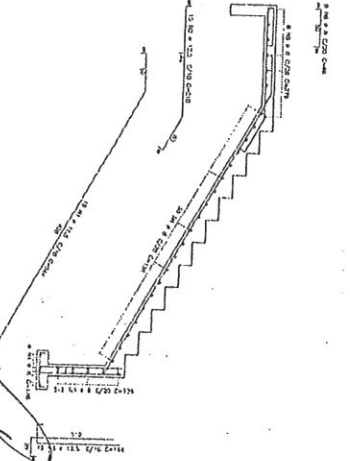

DIEGO FERNANDO LIMA
 ENG. CIVIL - CREA: 56373-D
 CPF: 022.224.053-94

Item	Descrição	Quantidade	Valor Unitário	Valor Total
1
2
3
4
5
6
7
8
9
10
11
12
13
14
15
16
17
18
19
20
21
22
23
24
25
26
27
28
29
30
31
32
33
34
35
36
37
38
39
40
41
42
43
44
45
46
47
48
49
50
51
52
53
54
55
56
57
58
59
60
61
62
63
64
65
66
67
68
69
70
71
72
73
74
75
76
77
78
79
80
81
82
83
84
85
86
87
88
89
90
91
92
93
94
95
96
97
98
99
100

Item	Descrição	Quantidade	Valor Unitário	Valor Total
1
2
3
4
5
6
7
8
9
10
11
12
13
14
15
16
17
18
19
20
21
22
23
24
25
26
27
28
29
30
31
32
33
34
35
36
37
38
39
40
41
42
43
44
45
46
47
48
49
50
51
52
53
54
55
56
57
58
59
60
61
62
63
64
65
66
67
68
69
70
71
72
73
74
75
76
77
78
79
80
81
82
83
84
85
86
87
88
89
90
91
92
93
94
95
96
97
98
99
100

SUPERIORE
 ESCOLA MUNICIPAL ESTADUAL

Responsável Técnico:
JUAREZ SANT'ANNA
 CRÉDITO Nº 1284-A
 OAB/RS Nº 1284-A

Projeto de Engenharia
 Rua Professor Carlos Prado, 430 - Sala 218 - Fone: 3333-3333
 CEP: 91220-000 - Porto Alegre - RS

Projeto de Arquitetura
 Rua Professor Carlos Prado, 430 - Sala 218 - Fone: 3333-3333
 CEP: 91220-000 - Porto Alegre - RS

ARM. NEG. LAJES 1o. E 2o. ETIPOS - (1o. E 2o. PAV.)

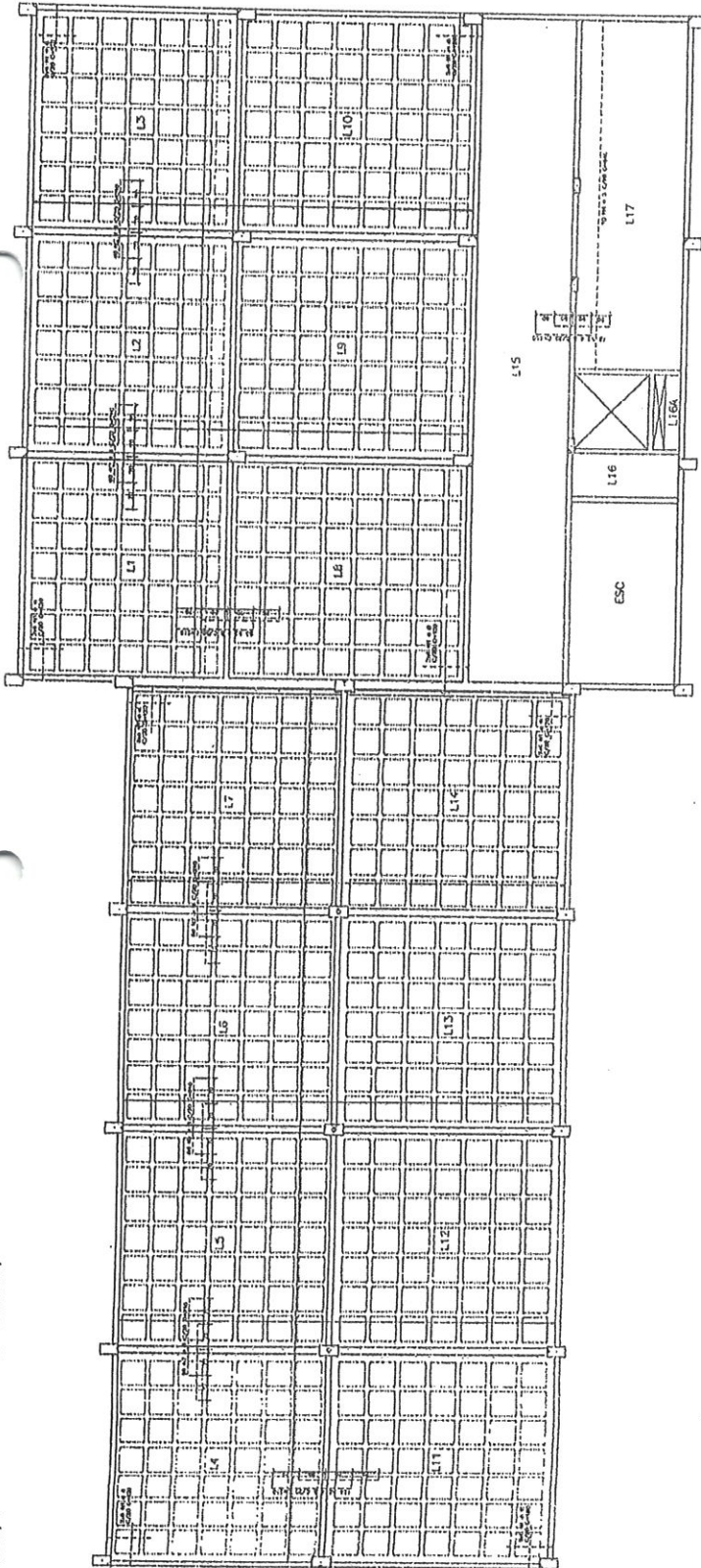

ARM. POS. LAJES 1o. E 2o. ETIPOS - (1o. E 2o. PAV.)

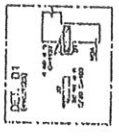
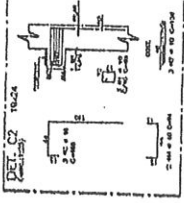
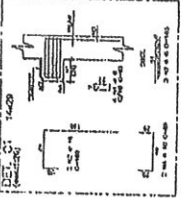
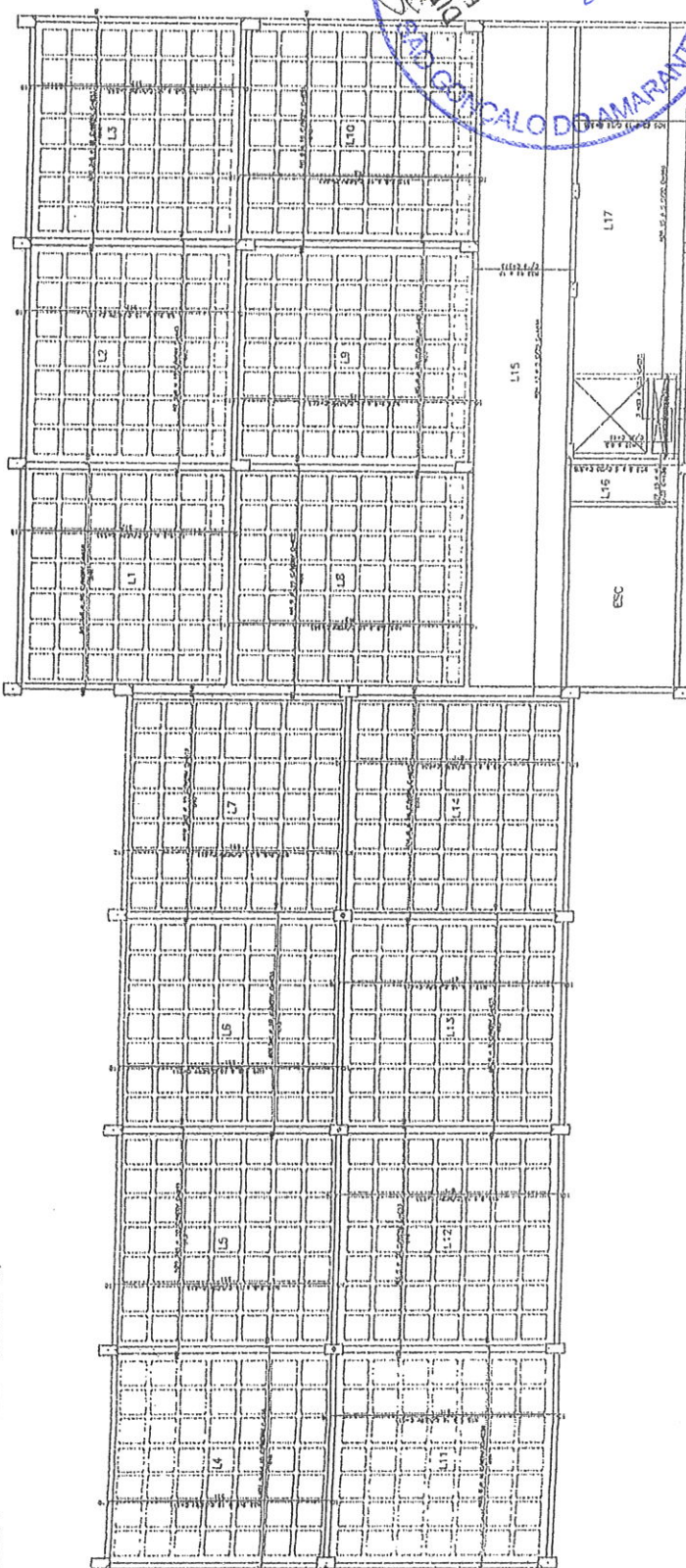

ITEM	DESCRIPCION	CANTIDAD	UNIDAD
1
2
3
4
5
6
7
8
9
10
11
12
13
14
15
16
17
18
19
20
21
22
23
24
25
26
27
28
29
30
31
32
33
34
35
36
37
38
39
40
41
42
43
44
45
46
47
48
49
50

ITEM	DESCRIPCION	CANTIDAD	UNIDAD
1
2
3
4
5
6
7
8
9
10
11
12
13
14
15
16
17
18
19
20
21
22
23
24
25
26
27
28
29
30
31
32
33
34
35
36
37
38
39
40
41
42
43
44
45
46
47
48
49
50

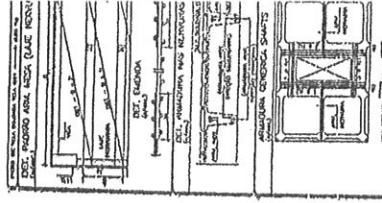

ITEM	DESCRIPCION	CANTIDAD	UNIDAD
1
2
3
4
5
6
7
8
9
10
11
12
13
14
15
16
17
18
19
20
21
22
23
24
25
26
27
28
29
30
31
32
33
34
35
36
37
38
39
40
41
42
43
44
45
46
47
48
49
50

ITEM	DESCRIPCION	CANTIDAD	UNIDAD
1
2
3
4
5
6
7
8
9
10
11
12
13
14
15
16
17
18
19
20
21
22
23
24
25
26
27
28
29
30
31
32
33
34
35
36
37
38
39
40
41
42
43
44
45
46
47
48
49
50

ITEM	DESCRIPCION	CANTIDAD	UNIDAD
1
2
3
4
5
6
7
8
9
10
11
12
13
14
15
16
17
18
19
20
21
22
23
24
25
26
27
28
29
30
31
32
33
34
35
36
37
38
39
40
41
42
43
44
45
46
47
48
49
50

DIAGO FERNANDO LIMA
 ING. CIVIL
 C.R. 022 231 053 94
 PERMANENTE
 525
 A



Responsable Técnico:
 JUAREZ SANTIAGO
 C.R. 022 231 053 94
 Oficina de Ingeniería

SUPERIORE
 INGENIERIA CIVIL

TEL: (051) 327 26 2728
 email: superioresuperior@ig
 (Superioresuperior)
 Calle Los Olivos 200 - San José - Perú
 (Módulo 10 - C. 200 - 100 - 100)

